

TRESPA® TOPLAB® VERTICAL



FUTURE-PROOFED
TO INSPIRE
ELEGANCE
MADE TO LAST

TRESPA®

Future-proofed to inspire

Innovative materials, engineered to withstand the conditions of the most challenging work environments. Made with a strong dedication to style, in order to assist designers in search of a suitable colour choice for their most ambitious projects. With Trespa® TopLab® VERTICAL, Trespa provides a unique solution for vertical applications in those sectors where high performance is a must.



FUTURE
PROOFED

TRESPA® TOPLAB® VERTICAL

From healthcare labs to cleanrooms, from educational to institutional buildings, several environments require a wide range of vertical applications where no compromise can be made on easy cleanability, durability and especially hygiene. When it comes to functional cabinetry and integrated wall cladding solutions, special coverings for modular elements, the lining of fume hoods and splash backs, Trespa® TopLab® VERTICAL is the preferred choice of some of the world's most demanding customers.



LABS &
CLEAN ROOMS



HEALTHCARE



EDUCATION



Trespa® TopLab® VERTICAL K05.0.0 Pure White
Trespa® TopLab® VERTICAL KNW18 Light Mahogany

Why TRESPA® TOPLAB® VERTICAL in one glance



CHEMICAL
RESISTANCE

Based on multiple test methods



DOES NOT
SUPPORT BACTERIAL
GROWTH

Thanks to our surface
technology developed in-house



SCRATCH
& WEAR
RESISTANCE

Tested with diamond-tip point
and abrasive paper



IMPACT
RESISTANCE

Solid and sturdy panels
for everyday use



EASY
TO CLEAN

Proven by third-party
evaluations



SUITABLE
FOR CONTACT
WITH FOOD

Tested according
to international standards



SMOOTH
MACHINABILITY

Comparable to
high quality hardwood



QUICK
INSTALLATION

Using various visible
or invisible fixing solutions



Trespa® TopLab®^{VERTICAL} K05.0.0 Pure White
Trespa® TopLab®^{VERTICAL} KNW18 Light Mahogany



Enhanced properties through Electron Beam Curing

Electron Beam Curing, developed in-house by Trespa, represents a major contribution to innovation in the field of scientific surfaces. Using this fast, non-thermal curing method, Trespa® TopLab® VERTICAL decorative surfaces are hardened via high-energy electron emissions at a controlled rate. The resulting closed surface enables unique surface performance, in terms of resistance and colour stability: it encompasses a remarkable range of properties, to serve the needs of the most demanding professional environments.



Trespa® TopLab® VERTICAL K04.0.2 Pale Yellow
Trespa® TopLab® VERTICAL K22.2.4 Powder Blue
Trespa® TopLab® VERTICAL K03.1.0 Pastel Grey

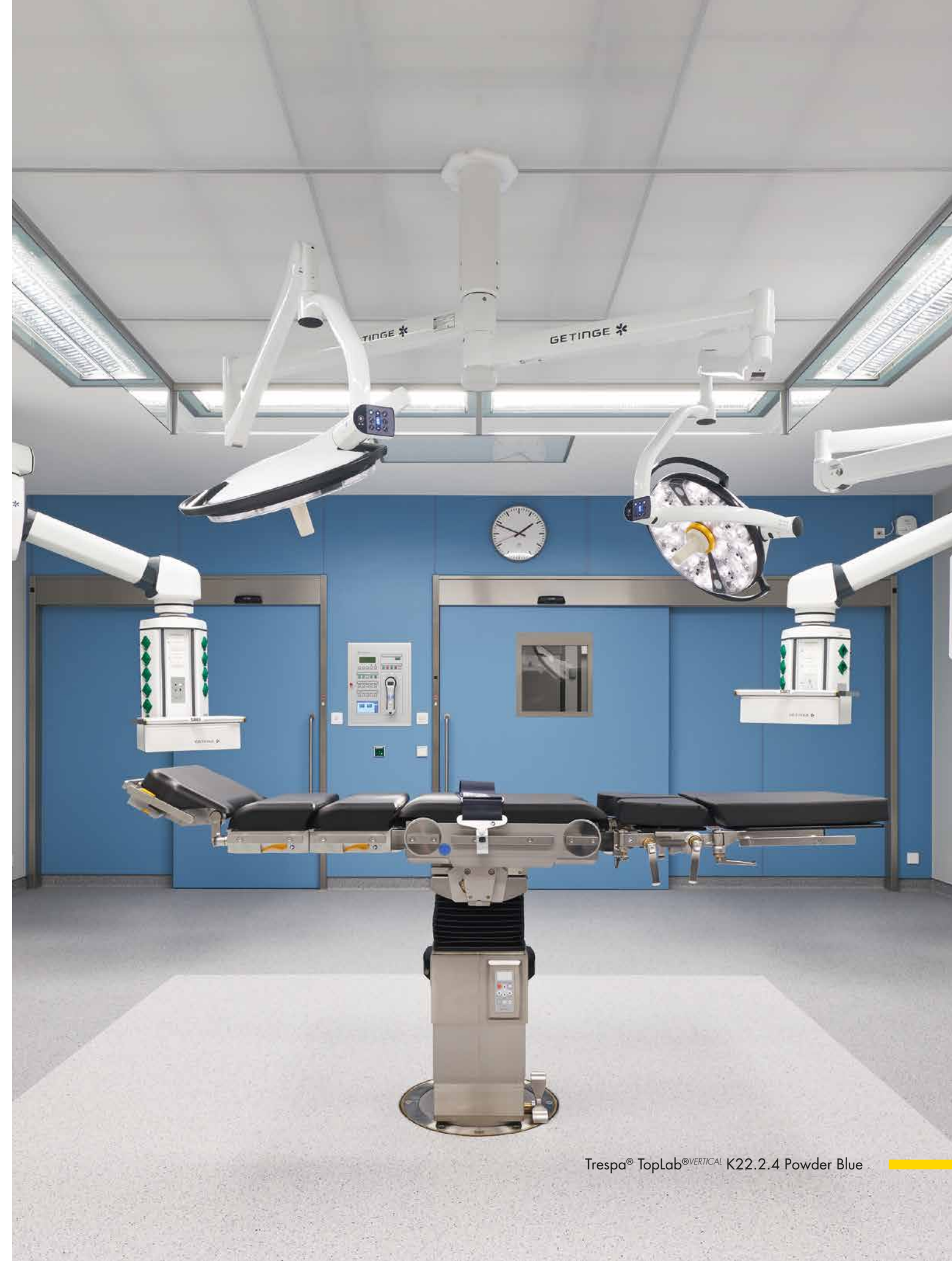

Trespa® TopLab® VERTICAL K22.2.4 Powder Blue

The pleasure of choice

In order to suit perfectly a wide variety of applications, Trespa® TopLab® VERTICAL features a remarkably broad collection of colours and finishings. From more contemporary patterns to traditional tones, designers can choose among over 100 different sources of inspiration, including the pioneering Lumen, Metallics and Focus ranges.



Trespa® TopLab® VERTICAL KM0551 Titanium Bronze

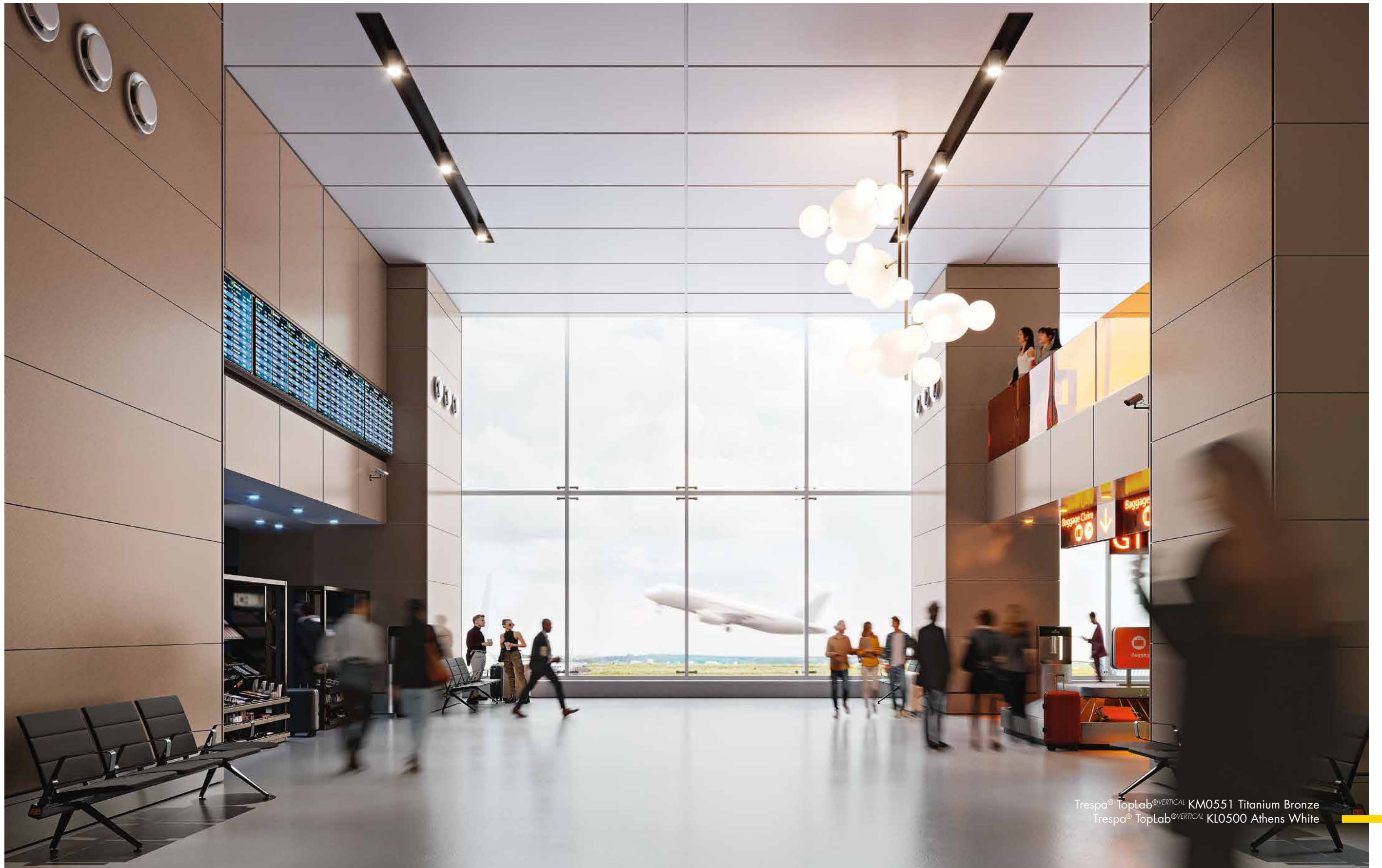

Trespa® TopLab®VERTICAL KM0551 Titanium Bronze
Trespa® TopLab®VERTICAL KL0500 Athens White

UNI COLOURS

K03.0.0 White	K03.1.0 Pastel Grey	K03.4.0 Silver Grey	K04.0.0 Cream White	K04.0.1 Pearl Yellow	K04.0.2 Pale Yellow	K04.0.5 Zinc Yellow
K04.1.7 Gold Yellow	K05.0.0 Pure White	K05.1.0 Papyrus White	K05.1.1 Stone Beige	K05.1.2 Champagne	K05.1.4 Sun Yellow	K05.5.0 Quartz Grey
K06.3.5 Ochre	K06.5.1 Toscana Greige	K06.7.1 Natural Greige	K07.1.1 Sand	K08.2.1 Mid Beige	K08.2.3 Salmon	K08.3.1 Stone Grey
K08.4.5 Rusty Red	K08.8.1 Dark Brown	K09.6.4 Mahogany Red	K10.1.8 Red Orange	K10.3.4 Terra Cotta	K10.4.5 Sienna Brown	K10.6.1 Taupe
K11.4.4 English Red	K11.8.0 Ceramic Greige	K12.1.8 Passion Red	K12.2.5 Motion Red	K12.3.7 Carmine Red	K12.4.5 East Red	K12.6.3 Wine Red
K14.7.2 Deep Red Brown	K17.3.5 Cyclam	K18.0.1 Mystic White*	K19.7.1 Charcoal Grey	K20.5.2 Lavender Blue	K20.7.2 Dark Blue	K21.1.0 Winter Grey
K21.5.1 Mid Grey	K21.5.4 Cobalt Blue	K21.7.0 Steel Grey	K22.1.6 Royal Blue	K22.2.1 Bluish Grey	K22.2.4 Powder Blue	K22.3.1 Ocean Grey
K22.4.4 Brilliant Blue	K22.6.2 Dark Denim	K23.0.4 Mineral Blue	K24.4.1 Steel Blue	K25.8.1 Anthracite Grey	K26.5.4 Pacific	K28.2.1 Aquamarine
K28.6.2 Mid Green	K30.3.2 Verdigris	K31.4.1 Zinc Grey	K32.2.1 Translucent Green	K32.7.2 Dark Green	K33.3.6 Brilliant Green	K34.8.1 Forest Green
K35.4.0 Cactus Green	K36.3.5 Turf Green	K37.0.8 Lime Green	K37.2.3 Spring Green	K41.0.6 Mojito Green	K70.0.0 Slate Grey	K90.0.0 Black

*special conditions apply

WOOD DECORS

KNW02 Elegant Oak	KNW03 Harmony Oak	KNW04 Pacific Board	KNW05 Loft Brown	KNW06 Montreux Amber	KNW07 Montreux Sunglow	KNW08 Italian Walnut
KNW09 Wenge	KNW10 English Cherry	KNW11 Santos Palisander	KNW12 Natural Bagenda	KNW13 Country Wood	KNW14 French Walnut	KNW15 Milano Sabbia
KNW16 Milano Terra	KNW17 Milano Grigio	KNW18 Light Mahogany	KNW19 Dark Mahogany	KNW22 Slate Wood	KNW23 Nordic Black	KNW24 Greyed Cedar
KNW25 Hesbania	KNW26 Core Ash	KNW27 Denver Oak	KNW28 Halmstad	KNW29 Woodstone	KNW30 Tropical Ipe	KNW31 Western Red Cedar

NATURALS

KNA12 Natural Chalk Stone	KNA13 Silver Quartzite	KNA14 Weathered Basalt	KNA15 Indian Terra Cotta	KNA16 Belgio Bluestone	KNA17 Natural Graphite	KNA18 Natural Slate
KNA19 Italian Slate	KNM01 Rusted Brown	KNM02 Forged Alloy	KNM03 Corroded Green	KNM04 Sintered Alloy	KNM05 Hardened Brown	KNM06 Tempered Grey
KNM07 Casted Grey	KNM08 Casted White					

METALLICS

KM0441 Titanium Silver	KM0551 Titanium Bronze	KM0561 Urban Brown	KM0641 Amber	KM2134 Azurite Blue	KM2181 Graphite Grey	KM5101 Aluminium Grey
KM5102 Urban Grey	KM5301 Copper Red	KM5302 Copper Yellow				

LUMEN



FOCUS



Order your samples now!

		TRESPA® TOPLAB® VERTICAL
SURFACE	EBC technology	•
CORE		Black
THICKNESSES	6 mm (≈1/4 inch)	•
	8 mm (≈5/16 inch)	•
	10 mm (≈3/8 inch)	•
	13 mm (≈1/2 inch)	•
FINISHES	Satin	☐ ☐ ☐ ☐
	Matt	☐ ☐ ☐ ☐
	Rock	☐ ☐ ☐
	Matt-Rock	☐
	Diffuse	☐ ☐ *

*with satin reverse

☐ **SINGLE SIDED DECORATIVE**
Decorative side with non decorative black reverse.

☐☐ **DOUBLE SIDED DECORATIVE**
Same colour for front and reverse side of the panel.

☐☐ **DUOCOLOUR**
Different colour for front and reverse side of the panel.

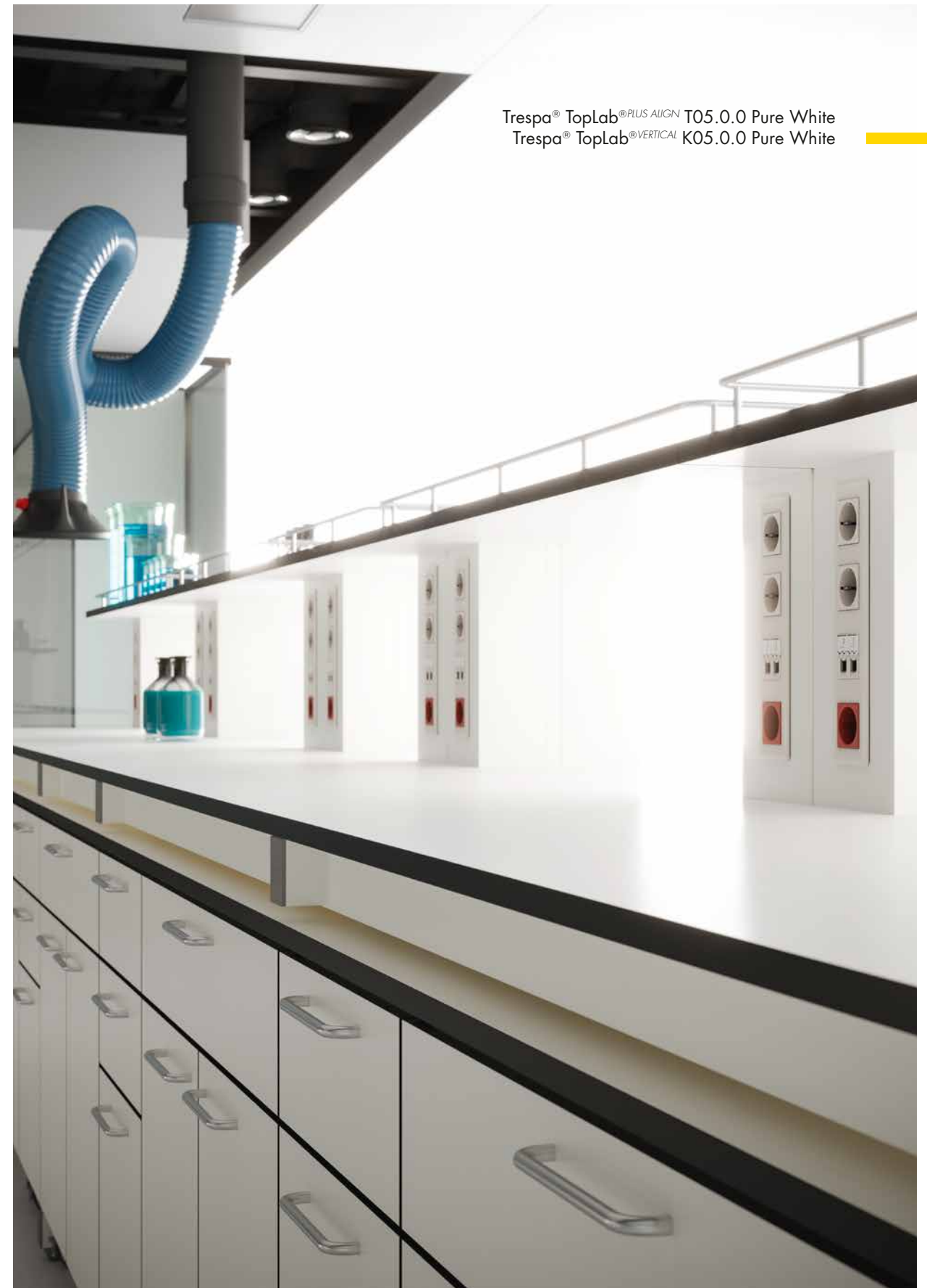

Trespa® TopLab® PLUS ALIGN T05.0.0 Pure White
Trespa® TopLab® VERTICAL K05.0.0 Pure White



Trespa® TopLab®^{PLUS ALIGN} T05.0.0 Pure White
Trespa® TopLab®^{VERTICAL} K05.0.0 Pure White

Trespa® TopLab® quality: guaranteed and certified

10-YEAR PRODUCT WARRANTY

Our panels are born to last. We want our customers to feel as confident as we are about the durability of the Trespa® TopLab® VERTICAL range. This is why we offer a 10-year conditional warranty on our product lines. To learn more about our warranty, please visit Trespa.info.



TESTING, CERTIFICATION AND BRANCH ASSOCIATIONS

Trespa products for scientific surface solutions are tested and certified according to international standards in relation to chemical resistance, low emission, food contact, cleanliness and other properties. Trespa® TopLab® VERTICAL is certified under the GREENGUARD Gold Certification program and ISEGA Certification program, as well as certified for certain cleanliness properties by Fraunhofer IPA under the Cleanroom Suitable Materials scheme. Trespa International B.V. is a member of SEFA (Scientific Equipment and Furniture Association), EGNATON (European Association for Sustainable Laboratory Technologies) and VIP3000 (Association for Cleanrooms and Pharmaceutical Construction).

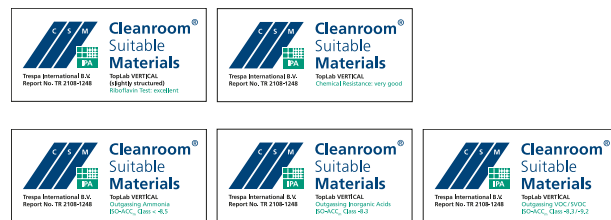

OUR COMMITMENT TO RENEWABLE RESOURCES

Trespa® TopLab® VERTICAL is available as part of the Programme for the Endorsement of Forest Certification™ (PEFC™) or Forestry Stewardship Council™ (FSC™) certification upon request for restricted quantities and jurisdictions. The use of FSC™ and PEFC™ certified Trespa panels may also count towards points for green building certification systems such as LEED, BREEAM and DGNB. These certifications are part of the initiatives resulting from Trespa's Sustainability Policy, through which the company shows its commitment to the use of raw materials from sustainable sources and to forest preservation. The Trespa® TopLab® line has been granted an Environmental Product Declaration issued by EPD International AB.



TO
INSPIRE

CONTACT US

TRESPA INTERNATIONAL B.V.

P.O. Box 110, 6000 AC Weert
Wetering 20, 6002 SM Weert
The Netherlands
www.trespa.com

EMEA, APAC, SOUTH AMERICA

Tel: +31 (0) 495 458 856
Info.TopLab@Trespa.com

NORTH AMERICA, CANADA

Tel: +1-800-487-3772
Info.TopLab.NA@Trespa.com

CHINA

Tel: +86 (0) 21 6288 1299 665
Info.TopLab.CN@Trespa.com

VISIT US

TRESPA DESIGN CENTRE WEERT

Wetering 20
6002 SM Weert
The Netherlands
Tel: +31 (0) 495 458 845
TDC.Weert@Trespa.com
www.trespa.com/tdc

TRESPA DESIGN CENTRE BARCELONA

Calle Ribera 5,
08003 Barcelona
Spain
Tel: +34 (0) 93 295 4193
TDC.Barcelona@Trespa.com
www.trespa.com/tdc

TRESPA DESIGN CENTRE SANTIAGO

Eliodoro Yáñez 2831
Torre A - Local 1
Providencia, Santiago
Chile
Tel: +56 2 24069990
TDC.Santiago@Trespa.com
www.trespa.com/tdc

FOLLOW US



DISCLAIMER

GENERAL

These terms apply to the use of this document and such use automatically means that the other party agrees to these terms. The information provided by Trespa International B.V. ("Trespa") in this document is solely indicative. Trespa is unable to warrant the accuracy and completeness of this information. Trespa may change the information included in this document at any time and without further notice. Trespa's customers and third parties must ascertain that they have the most recent document (for the most recent version, please consult: www.trespa.com). No rights can be derived from the information provided; the use of the information is at the other party's risk and responsibility. Trespa does not warrant that the information in this document is suitable for the purpose for which it is consulted by the other party. This document does not contain any design, structural calculation, estimate or other warranty or representation that customers and third parties may rely on. This document does not guarantee any properties of Trespa products. Colours used in Trespa's communications (including but not limited to printed matter) and in samples of Trespa's products may differ from the colours of the Trespa products to be supplied. Samples are not intended for use in product tests and are not representative of characteristics of the Trespa

products. Trespa's products and samples are produced within the specified colour tolerances and the colours (of production batches) may differ, even if the same colour is used. The viewing angle also influences the colour perception. Metallic panels feature a surface whose colour appears to change based on the direction from which it is viewed. The specified colour stability and colour specifications relate only to the decorative surface of the Trespa products, not to the core material and samples of the Trespa products. Trespa products are delivered ex-works with straight, sawn sides. Customers and third parties must have a professional adviser inform them about (the suitability of) the Trespa products for all desired applications and about applicable laws and regulations. Trespa does not warrant the above. The most recent version of the current delivery programme and the Material Properties Datasheet can be found at www.trespa.info. Only the information in the most recent and valid Material Properties Datasheet should be used to select and provide advice regarding Trespa products. Trespa reserves the right to change (the specifications for) its products without prior notice.

LIABILITY

Trespa is not liable (neither contractual nor non-contractual) for any damage arising from or

related to the use of this document, except if and to the extent that such damage is the result of wilful misconduct or gross negligence on the part of Trespa and/or its management. The limitation of liability applies to all parties affiliated with Trespa, including but not limited to its officers, directors, employees, affiliated enterprises, suppliers, distributors, agents, and representatives.

GENERAL CONDITIONS

All oral and written statements, offers, quotations, sales, supplies, deliveries and/or agreements and all related activities of Trespa are governed by the Trespa General Terms and Conditions of Sale (Algemene verkoopvoorwaarden Trespa International B.V.) filed with the Chamber of Commerce and Industry for Noord- en Midden-Limburg in Venlo (NL) on February 20th, 2015 under number 24270677, which can be found on and downloaded from the Trespa website, www.trespa.com/documentation. All oral and written statements, offers, quotations, sales, supplies, deliveries and/or agreements and all related work of Trespa North America, Ltd. governed by the Trespa North America General Terms and Conditions of Sale, which can be found on and downloaded from the Trespa website, www.trespa.com/documentation. A copy of these general conditions of sale will be provided free of

charge on request. All general terms and conditions other than the conditions mentioned above are dismissed and do not apply, regardless of whether such terms and conditions are referred to on requests for offers, offer confirmations, stationery and/or other documents of the other party, even if Trespa does not expressly object to such terms and conditions.

INTELLECTUAL PROPERTY

All intellectual property rights and other rights regarding the content of this document (including logos, text and photographs) are owned by Trespa and/or its licensors. Any use of the content of this document, including distribution, reproduction, disclosure, storage in an automated data file or the dispatch of such a file without Trespa's prior written consent is explicitly prohibited. ® Trespa, Meteon, Pura, Pura NFC, Athlon, Izeon, TopLab, TopLab^{PLUS}, TopLab^{PLUS} ALIGN, TopLab^{ECO}FIBRE, TopLab^{VERTICAL}, TopLab^{BASE}, Trespa Essentials and Mystic Metallics, Virtuo, Volkern are registered trademarks of Trespa.

QUESTIONS

Should you have any questions or comments, please do not hesitate to contact Trespa.



I4714-432672 • VERSION 2.0
BROCHURE CODE I4714 • DATE 09-2022

VISIT TRESPA.COM FOR THE MOST
UP TO DATE VERSION OF THIS DOCUMENT.

TRESPA®