

TRESPA® TOPLAB® VERTICAL



COLOUR
CARD

**FUTURE-PROOFED
TO INSPIRE**

TRES|SPA®

UNI COLOURS

K05.0.0 Pure White	K21.1.0 Winter Grey	K22.2.1 Bluish Grey	K28.2.1 Aquamarine	K23.0.4 Mineral Blue	K22.1.6 Royal Blue	K22.4.4 Brilliant Blue
K18.0.1 Mystic White*	K03.1.0 Pastel Grey	K22.3.1 Ocean Grey	K24.4.1 Steel Blue	K22.2.4 Powder Blue	K22.6.2 Dark Denim	K21.5.4 Cobalt Blue
K03.0.0 White	K05.1.1 Stone Beige	K03.4.0 Silver Grey	K32.2.1 Translucent Green	K37.2.3 Spring Green	K35.4.0 Cactus Green	K26.5.4 Pacific
K05.1.0 Papyrus White	K08.2.1 Mid Beige	K08.3.1 Stone Grey	K30.3.2 Verdigris	K28.6.2 Mid Green	K20.5.2 Lavender Blue	K20.7.2 Dark Blue
K04.0.0 Cream White	K41.0.6 Mojito Green	K37.0.8 Lime Green	K36.3.5 Turf Green	K33.3.6 Brilliant Green	K32.7.2 Dark Green	K34.8.1 Forest Green
K04.0.1 Pearl Yellow	K04.0.5 Zinc Yellow	K04.1.7 Gold Yellow	K10.1.8 Red Orange	K12.1.8 Passion Red	K12.2.5 Motion Red	K12.3.7 Carmine Red
K04.0.2 Pale Yellow	K05.1.4 Sun Yellow	K08.2.3 Salmon	K10.3.4 Terra Cotta	K11.4.4 English Red	K10.4.5 Sienna Brown	K17.3.5 Cyclam
K05.1.2 Champagne	K07.1.1 Sand	K06.3.5 Ochre	K08.4.5 Rusty Red	K09.6.4 Mahogany Red	K12.4.5 East Red	K12.6.3 Wine Red

K31.4.1 Zinc Grey	K21.5.1 Mid Grey	K70.0.0 Slate Grey	K21.7.0 Steel Grey	K11.8.0 Ceramic Greige	K08.8.1 Dark Brown	K14.7.2 Deep Red Brown
K05.5.0 Quartz Grey	K10.6.1 Taupe	K06.5.1 Toscana Greige	K06.7.1 Natural Greige	K19.7.1 Charcoal Grey	K25.8.1 Anthracite Grey	K90.0.0 Black

*special conditions apply

Order your samples now!

https://www.trespa.com/en_GB/products/toplab-vertical-uni-colours

WOOD DECORS

KNW26 Core Ash	KNW29 Woodstone	KNW28 Halmstad	KNW24 Greyed Cedar	KNW17 Milano Grigio	KNW25 Hesbania	KNW22 Slate Wood
KNW27 Denver Oak	KNW02 Elegant Oak	KNW16 Milano Terra	KNW05 Loft Brown	KNW11 Santos Palisander	KNW13 Country Wood	KNW23 Nordic Black
KNW15 Milano Sabbia	KNW14 French Walnut	KNW03 Harmony Oak	KNW10 English Cherry	KNW04 Pacific Board	KNW30 Tropical Ipe	KNW09 Wenge
KNW12 Natural Bagenda	KNW06 Montreux Amber	KNW07 Montreux Sunglow	KNW31 Western Red Cedar	KNW08 Italian Walnut	KNW18 Light Mahogany	KNW19 Dark Mahogany

Order your samples now!

https://www.trespa.com/en_GB/products/toplab-vertical-wood

NATURALS

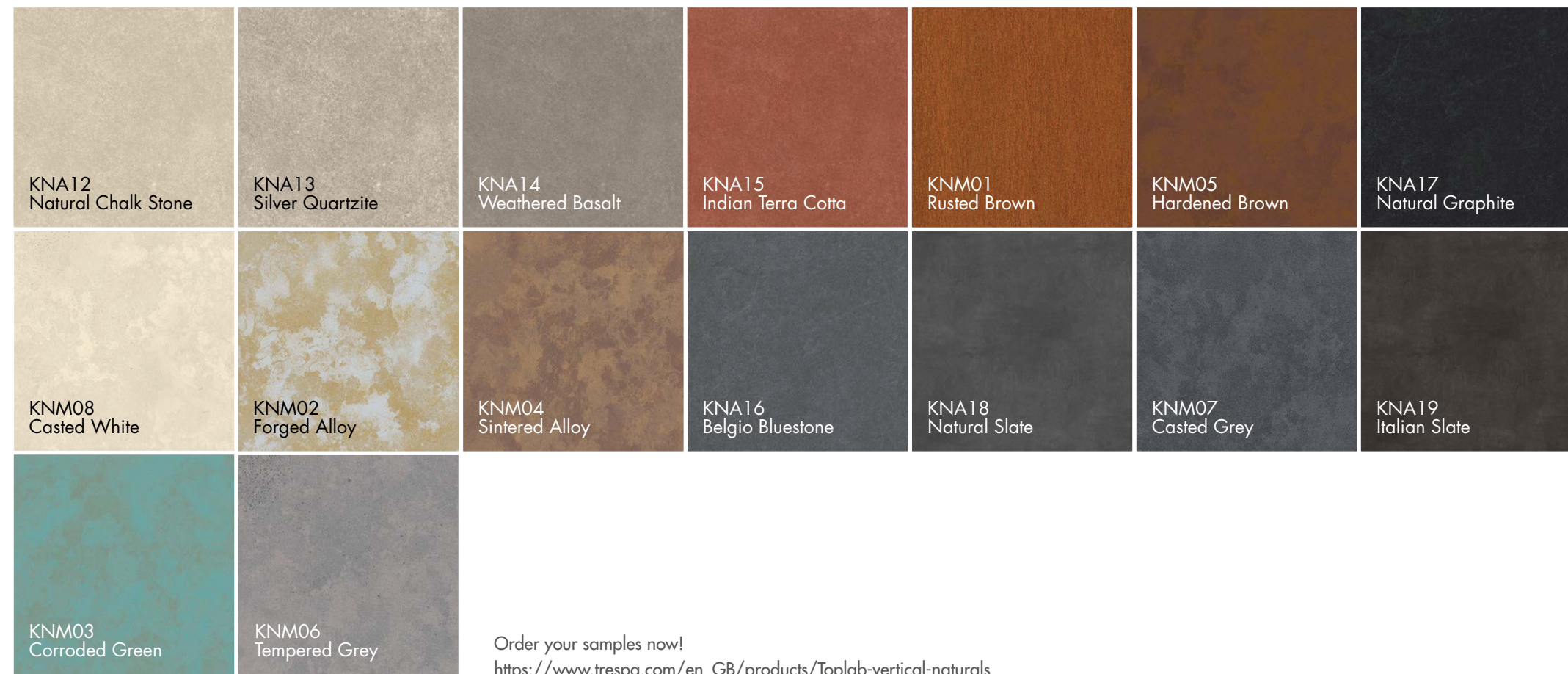

Order your samples now!
https://www.trespa.com/en_GB/products/Toplab-vertical-naturals

METALLICS



Order your samples now!
https://www.trespa.com/en_GB/products/toplab-vertical-metallics

SIZES

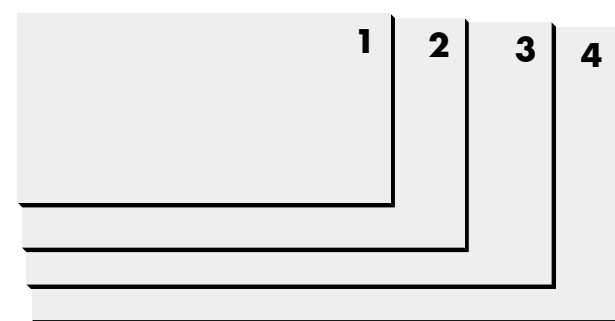

- 1 2550 x 1860 mm (≈ 100 x 73 inch)
- 2 3050 x 1530 mm (≈ 120 x 60 inch)
- 3 3650 x 1860 mm (≈ 143 x 73 inch)
- 4 4270 x 2130 mm (≈ 168 x 83 inch)*

* The large size of this panel allows an efficient machining of the product.

THICKNESSES

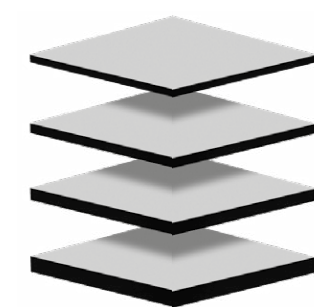

- 6 mm (≈ 1/4 inch)
- 8 mm (≈ 5/16 inch)
- 10 mm (≈ 3/8 inch)
- 13 mm (≈ 1/2 inch)

LUMEN



**Available september 2022

Order your samples now!
https://www.trespa.com/en_GB/products/toplab-vertical-lumen

FOCUS



Order your samples now!
https://www.trespa.com/en_GB/products/toplab-vertical-focus

FINISHES



NOTE

Please BE AWARE that not all product-finish combinations are possible. For available sheet sizes, thicknesses and finishes in your country, please check [trespa.info](https://www.trespa.info) for the detailed and up to date delivery programme and material property datasheet.

UNI COLOURS

Colour code	Colour name	Satin			Rock		
		□	◻	◻*	□	◻	◻*
K03.0.0	White	•	•	•	•	•	•
K03.1.0	Pastel Grey	•	•	•	•	•	•
K03.4.0	Silver Grey	•	•	•	•	•	•
K04.0.0	Cream White	•	•	•	•	•	•
K04.0.1	Pearl Yellow	•	•	•	•	•	•
K04.0.2	Pale Yellow	•	•	•	•	•	•
K04.0.5	Zinc Yellow	•	•	•	•	•	•
K04.1.7	Gold Yellow	•	•	•	•	•	•
K05.0.0	Pure White	•	•	•	•	•	•
K05.1.0	Papyrus White	•	•	•	•	•	•
K05.1.1	Stone Beige	•	•	•	•	•	•
K05.1.2	Champagne	•	•	•	•	•	•
K05.1.4	Sun Yellow	•	•	•	•	•	•
K05.5.0	Quartz Grey	•	•	•	•	•	•
K06.3.5	Ochre	•	•	•	•	•	•
K06.5.1	Toscana Greige	•	•	•	•	•	•
K06.7.1	Natural Greige	•	•	•	•	•	•
K07.1.1	Sand	•	•	•	•	•	•
K08.2.1	Mid Beige	•	•	•	•	•	•
K08.2.3	Salmon	•	•	•	•	•	•
K08.3.1	Stone Grey	•	•	•	•	•	•
K08.4.5	Rusty Red	•	•	•	•	•	•
K08.8.1	Dark Brown	•	•	•	•	•	•
K09.6.4	Mahogany Red	•	•	•	•	•	•
K10.1.8	Red Orange	•	•	•	•	•	•
K10.3.4	Terra Cotta	•	•	•	•	•	•
K10.4.5	Sienna Brown	•	•	•	•	•	•
K10.6.1	Taupe	•	•	•	•	•	•
K11.4.4	English Red	•	•	•	•	•	•
K11.8.0	Ceramic Greige	•	•	•	•	•	•
K12.1.8	Passion Red	•	•	•	•	•	•
K12.2.5	Motion Red	•	•	•	•	•	•
K12.3.7	Carmine Red	•	•	•	•	•	•
K12.4.5	East Red	•	•	•	•	•	•
K12.6.3	Wine Red	•	•	•	•	•	•
K14.7.2	Deep Red Brown	•	•	•	•	•	•
K17.3.5	Cyclam	•	•	•	•	•	•
K18.0.1	Mystic White**	•	•	•	•	•	•
K19.7.1	Charcoal Grey	•	•	•	•	•	•
K20.5.2	Lavender Blue	•	•	•	•	•	•
K20.7.2	Dark Blue	•	•	•	•	•	•
K21.1.0	Winter Grey	•	•	•	•	•	•
K21.5.1	Mid Grey	•	•	•	•	•	•
K21.5.4	Cobalt Blue	•	•	•	•	•	•
K21.7.0	Steel Grey	•	•	•	•	•	•
K22.1.6	Royal Blue	•	•	•	•	•	•
K22.2.1	Bluish Grey	•	•	•	•	•	•
K22.2.4	Powder Blue	•	•	•	•	•	•
K22.3.1	Ocean Grey	•	•	•	•	•	•
K22.4.4	Brilliant Blue	•	•	•	•	•	•
K22.6.2	Dark Denim	•	•	•	•	•	•
K23.0.4	Mineral Blue	•	•	•	•	•	•
K24.4.1	Steel Blue	•	•	•	•	•	•
K25.8.1	Anthracite Grey	•	•	•	•	•	•
K26.5.4	Pacific	•	•	•	•	•	•
K28.2.1	Aquamarine	•	•	•	•	•	•
K28.6.2	Mid Green	•	•	•	•	•	•
K30.3.2	Verdigris	•	•	•	•	•	•
K31.4.1	Zinc Grey	•	•	•	•	•	•
K32.2.1	Translucent Green	•	•	•	•	•	•
K32.7.2	Dark Green	•	•	•	•	•	•
K33.3.6	Brilliant Green	•	•	•	•	•	•
K34.8.1	Forest Green	•	•	•	•	•	•
K35.4.0	Cactus Green	•	•	•	•	•	•
K36.3.5	Turf Green	•	•	•	•	•	•
K37.0.8	Lime Green	•	•	•	•	•	•
K37.2.3	Spring Green	•	•	•	•	•	•
K41.0.6	Mojito Green	•	•	•	•	•	•
K70.0.0	Slate Grey	•	•	•	•	•	•
K90.0.0	Black	•	•	•	•	•	•

*With Satin reverse
**Special conditions apply

WOOD DECORS

Colour code	Colour name	Satin			Matt		
		□	◻	◻*	□	◻	◻*
KNW02	Elegant Oak	•	•	•	•	•	•
KNW03	Harmony Oak	•	•	•	•	•	•
KNW04	Pacific Board	•	•	•	•	•	•
KNW05	Loft Brown	•	•	•	•	•	•
KNW06	Montreux Amber	•	•	•	•	•	•
KNW07	Montreux Sunglow	•	•	•	•	•	•
KNW08	Italian Walnut	•	•	•	•	•	•
KNW09	Wenge	•	•	•	•	•	•
KNW10	English Cherry	•	•	•	•	•	•
KNW11	Santos Palisander	•	•	•	•	•	•
KNW12	Natural Bagenda	•	•	•	•	•	•
KNW13	Country Wood	•	•	•	•	•	•
KNW14	French Walnut	•	•	•	•	•	•
KNW15	Milano Sabbia	•	•	•	•	•	•
KNW16	Milano Terra	•	•	•	•	•	•
KNW17	Milano Grigio	•	•	•	•	•	•
KNW18	Light Mahogany	•	•	•	•	•	•
KNW19	Dark Mahogany	•	•	•	•	•	•
KNW22	Slate Wood	•	•	•	•	•	•
KNW23	Nordic Black	•	•	•	•	•	•
KNW24	Greyed Cedar	•	•	•	•	•	•
KNW25	Hesbania	•	•	•	•	•	•
KNW26	Core Ash	•	•	•	•	•	•
KNW27	Denver Oak	•	•	•	•	•	•
KNW28	Halmstad	•	•	•	•	•	•
KNW29	Woodstone	•	•	•	•	•	•
KNW30	Tropical Ipe	•	•	•	•	•	•
NW31	Western Red Cedar	•	•	•	•	•	•

Trespa® TopLab® Wood Decors panels feature a directional coloured surface. The grain of Trespa® TopLab® Wood Decors runs the length direction of the panel.

NATURALS

Colour code	Colour name	Matt		Matt-Rock
		□	◻*	
KNA12	Natural Chalkstone	•	•	•
KNA13	Silver Quartzite	•	•	•
KNA14	Weathered Basalt	•	•	•
KNA15	Indian Terra Cotta	•	•	•
KNA16	Belgian Bluestone	•	•	•
KNA17	Natural Graphite	•	•	•
KNA18	Natural Slate	•	•	•
KNA19	Italian Slate	•	•	•
With metallic effect				
KNM01	Rusted Brown	•	•	•
KNM02*	Forged Alloy	•	•	•
KNM03	Corroded Green	•	•	•
KNM04*	Sintered Alloy	•	•	•
KNM05*	Hardened Brown	•	•	•
KNM06*	Tempered Grey	•	•	•
KNM07*	Casted Grey	•	•	•
KNM08*	Crafted White	•	•	•

*Decors have gloss elements in the surface.
Trespa® TopLab® Naturals panels feature a directional coloured surface.

TYPES

- **SINGLE SIDED DECORATIVE**
Decorative side with non decorative black reverse.
- ◻ **DOUBLE SIDED DECORATIVE**
Same colour for front and reverse side of the panel.

- ◻ **DUOCOLOUR**
Different colour for front and reverse side of the panel.

PROJECT COLOURS

For Trespa® TopLab® Uni Colours and Metallics, Trespa is happy to create panels in bespoke colours for your project. Almost anything is possible, just tell us what you need. For more information please contact your local Trespa representative.

METALLICS

Colour code	Colour name	Satin		Rock	
		□	◻	□	◻
KM0441	Titanium Silver	•	•	•	•
KM0551	Titanium Bronze	•	•	•	•
KM0561	Urban Brown	•	•	•	•
KM0641	Amber	•	•	•	•
KM2134	Azurite Blue	•	•	•	•
KM2181	Graphite Grey	•	•	•	•
KM5101	Aluminium Grey	•	•	•	•
KM5102	Urban Grey	•	•	•	•
KM5301	Copper Red	•	•	•	•
KM5302	Copper Yellow	•	•	•	•

*With Satin reverse
Trespa® TopLab® Metallics panels feature a directional coloured surface.

LUMEN

Colour code	Colour name	Diffuse	
		□	◻*
KL0500	Athens White	•	•
KL0651	Italian Greige	•	•
KL1971	Iceland Grey	•	•
KL2151	London Grey	•	•
KL2581	New York Grey	•	•
KL3673	Olive Green	•	•
KL9000	Metropolis Black	•	•
KL2264	Oceania Blue**	•	•
With metallic effect			
KLM0561	Roman Bronze	•	•
KLM0641	China Gold	•	•
KLM1055	Persian Copper	•	•
KLM2181	Siberian Platinum	•	•
KM5101	Paris Silver	•	•

*With Satin reverse
**Available September 2022
Trespa® TopLab® Lumen diffuse and all lumen with metallic effect (products with KLM code) feature a directional coloured surface.

FOCUS

Colour code	Colour name	Diffuse
		□
KC0803	Brooklyn Classic	•
KC0821	Brooklyn Luna	•
KC0825	Brooklyn Antracite	•
KC0121	Chester Grey	•
With metallic effect		
KCM0306	Tribeca Gold	•
KCM0316	Tribeca Iron	•
KCM0324	Tribeca Zinc	•
KCM0903	Brooklyn Steel	•
KCM0906	Brooklyn Bronze	•
KCM0951	Brooklyn Aluminium	•

Trespa® TopLab® Focus panels feature a directional coloured surface.



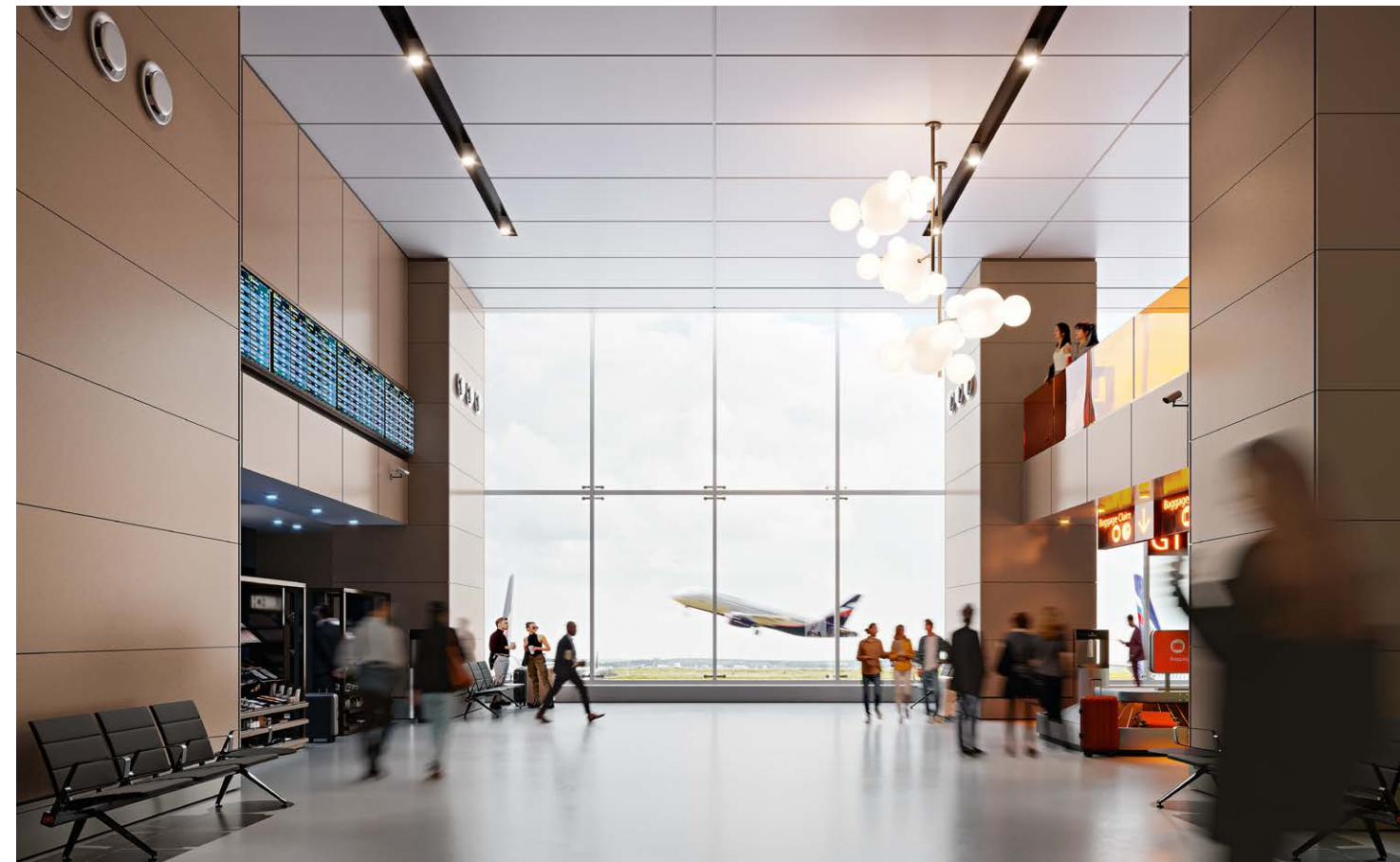
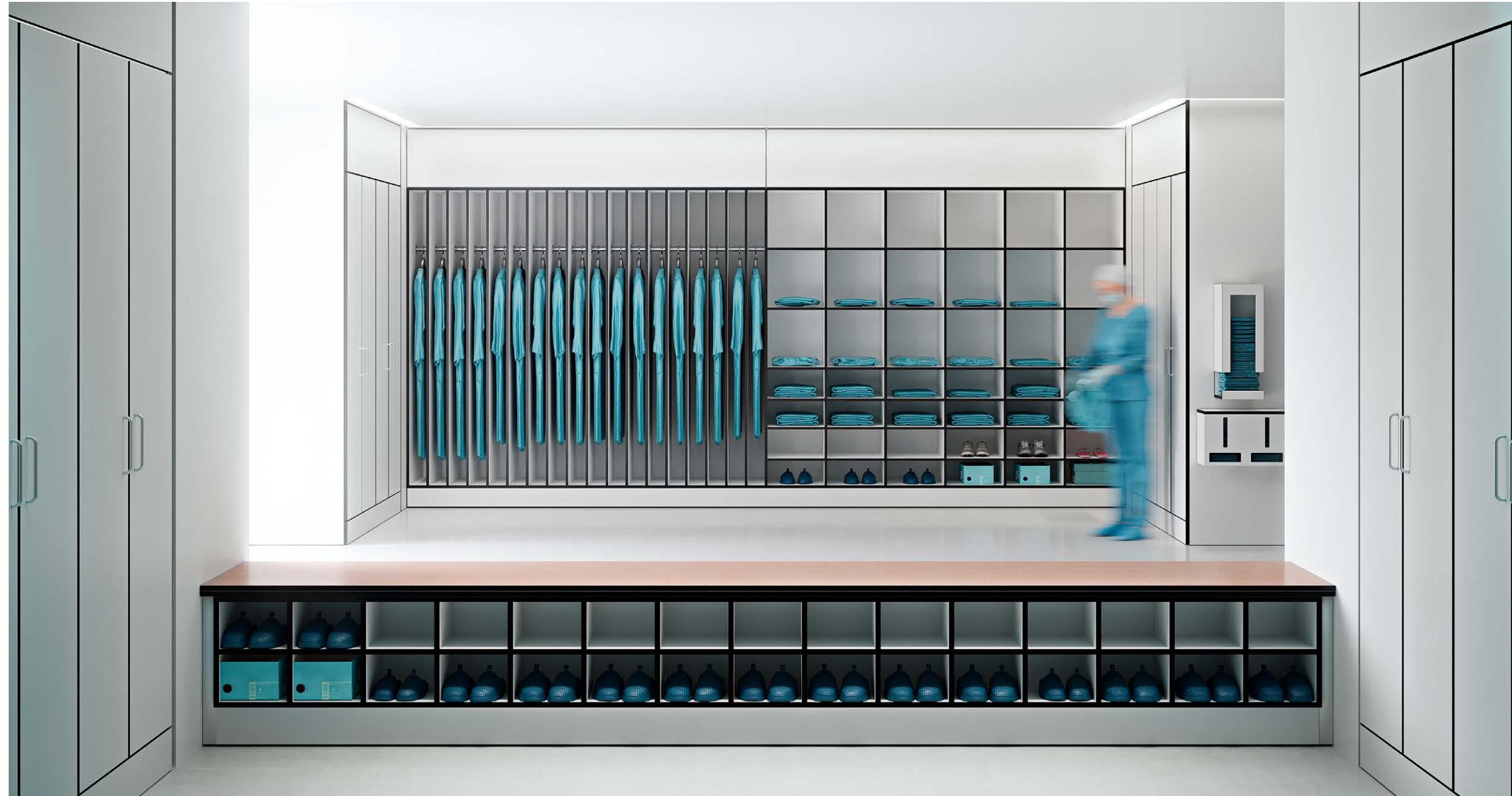

CONTACT US

TRESPA INTERNATIONAL B.V.

P.O. Box 110, 6000 AC Weert
Wetering 20, 6002 SM Weert
The Netherlands
www.trespa.com

EMEA, APAC, SOUTH AMERICA

Tel: +31 (0) 495 458 856
Info.TopLab@Trespa.com

NORTH AMERICA, CANADA

Tel: +1-800-487-3772
Info.TopLab.NA@Trespa.com

CHINA

Tel: +86 (0) 21 62881299
Info.TopLab.CN@Trespa.com

VISIT US

TRESPA DESIGN CENTRE WEERT

Wetering 20
6002 SM Weert
The Netherlands
Tel: +31 (0) 495 458 845
TDC.Weert@Trespa.com
www.trespa.com/tdc

TRESPA DESIGN CENTRE BARCELONA

Calle Ribera 5,
08003 Barcelona
Spain
Tel: +34 (0) 93 295 4193
TDC.Barcelona@Trespa.com
www.trespa.com/tdc

TRESPA DESIGN CENTRE SANTIAGO

Eliodoro Yáñez 2831
Torre A - Local 1
Providencia, Santiago
Chile
Tel: +56 2 24069990
TDC.Santiago@Trespa.com
www.trespa.com/tdc

FOLLOW US



DISCLAIMER

GENERAL

These terms apply to the use of this document and such use automatically means that the other party agrees to these terms. The information provided by Trespa International B.V. ("Trespa") in this document is solely indicative. Trespa is unable to warrant the accuracy and completeness of this information. Trespa may change the information included in this document at any time and without further notice. Trespa's customers and third parties must ascertain that they have the most recent document (for the most recent version, please consult: www.trespa.com). No rights can be derived from the information provided; the use of the information is at the other party's risk and responsibility. Trespa does not warrant that the information in this document is suitable for the purpose for which it is consulted by the other party. This document does not contain any design, structural calculation, estimate or other warranty or representation that customers and third parties may rely on. This document does not guarantee any properties of Trespa products. Colours used in Trespa's communications (including but not limited to printed matter) and in samples of Trespa's products may differ from the colours of the Trespa products to be supplied. Samples are not intended for use in product tests and are not representative of characteristics of the Trespa products. Trespa's products and samples are produced within the specified colour tolerances and the colours (of production batches) may differ, even if the same colour is used. The viewing angle also influences the colour perception. Metallic panels feature a surface whose colour appears to change based on the direction from which it is viewed. The specified colour stability and colour specifications relate only to the decorative surface of the Trespa products, not to the core material and samples of the Trespa products. Trespa products are delivered ex-works with straight, sawn sides. Customers and third parties must have a professional adviser inform them about (the suitability of) the Trespa products for all desired applications and about applicable laws and regulations. Trespa does not warrant the above. The most recent version of the current delivery programme and the Material Properties Datasheet can be found at www.trespa.info. Only the information in the most recent and valid Material Properties Datasheet should be used to select and provide advice regarding Trespa products. Trespa reserves the right to change (the specifications for) its products without prior notice.

LIABILITY

Trespa is not liable (neither contractual nor non-contractual) for any damage arising from or related to the use of this document, except if and to the extent that such damage is the result of wilful misconduct or gross negligence on the part of Trespa and/or its management. The limitation of liability applies to all parties affiliated with Trespa, including but not limited to its officers, directors, employees, affiliated enterprises, suppliers, distributors, agents, and representatives.

GENERAL CONDITIONS

All oral and written statements, offers, quotations, sales, supplies, deliveries and/or agreements and all related activities of Trespa are governed by the Trespa General Terms and Conditions of Sale (Algemene verkoopvoorwaarden Trespa International B.V.) filed with the Chamber of Commerce and Industry for Noord- en Midden-Limburg in Venlo (NL) on February 20th, 2015 under number 24270677, which can be found on and downloaded from the Trespa website, www.trespa.com/documentation. All oral and written statements, offers, quotations, sales, supplies, deliveries and/or agreements and all related work of Trespa North America, Ltd. governed by the Trespa North America General Terms and Conditions of Sale, which can be found on and downloaded from the Trespa website, www.trespa.com/documentation. A copy of these general conditions of sale will be provided free of charge on request. All general terms and conditions other than the conditions mentioned above are dismissed and do not apply, regardless of whether such terms and conditions are referred to on requests for offers, offer confirmations, stationery and/or other documents of the other party, even if Trespa does not expressly object to such terms and conditions.

INTELLECTUAL PROPERTY

All intellectual property rights and other rights regarding the content of this document (including logos, text and photographs) are owned by Trespa and/or its licensors. Any use of the content of this document, including distribution, reproduction, disclosure, storage in an automated data file or the dispatch of such a file without Trespa's prior written consent is explicitly prohibited. ® Trespa, Meteor, Pura, Pura NFC, Athlon, Izeon, TopLab, TopLab^{PLUS}, TopLab^{PLUS ALCON}, TopLab^{FCORBBE}, TopLab^{VERTICAL}, TopLab^{BASE}, Trespa Essentials and Mystic Metallics, Virtun, Volkem are registered trademarks of Trespa.

QUESTIONS

Should you have any questions or comments, please do not hesitate to contact Trespa.